

Machine Accessories

KEY TYPE DRILL CHUCKS



Taper Mounted

Capacity	Taper Mount	Model No.
0-1/4"	JT1	290-0001
0-3/8"	JT2	290-0002
0-1/2"	JT33	290-0003
0-1/2"	JT6	290-0004
1/32"-5/8"	JT3	290-0005
3/64 - 3/4"	JT3	290-0006
0-1/2"	JT6	290-0007
1/8"-5/8"	JT3	290-0008
3/16"-3/4"	JT3	290-0009
3/16"-1-1/32"	JT4	290-0010

Thread Mounted

Capacity	Thread Mount	Model No.
0-1/4"	3/8"-24UNF	290-0021
1/16"-3/8"	3/8"-24UNF	290-0022
0-3/8"	3/8"-24 UNF	290-0023
5/16"-1/2"	3/8"-24 UNF	290-0024
5/16"-1/2"	1/2"-20 UNF	290-0025
1/8"-5/8"	1/2"-20 UNF	290-0026
1/8"-5/8"	5/8"-16 UNF	290-0027
6mm	M10x1	290-0030
6mm	M12x1.25	290-0031
10mm	M10x1	290-0032
10mm	M12x1.25	290-0033
1.5-13mm	M12x1.25	290-0034
3-16mm	M12x1.25	290-0035
3-16mm	M16x1.5	290-0036

KEYLESS DRILL CHUCKS

Light duty Keyless Drill chuck



Thread mounted

Capacity	Thread Mount	Dimension DxLxI	Accuracy	Model No.	Accuracy	Model No.	Accuracy	Model No.
1-10mm	M10x1	42x86x78mm	0.14mm	290-7021	0.25mm	290-7121	0.35mm	290-7221
1-13mm	M12x1.25	44x90x81mm	0.14mm	290-7025	0.25mm	290-7125	0.35mm	290-7225
3-16mm	M16x1.5mm	48x102x92mm	0.20mm	290-7029	0.25mm	290-7129	0.35mm	290-7229
1/32"-3/8"	3/8"-24UNF	42x86x78mm	0.14mm	290-7049	0.25mm	290-7149	0.35mm	290-7249
1/32"-3/8"	1/2"-20UNF	42x86x78mm	0.14mm	290-7051	0.25mm	290-7151	0.35mm	290-7251
1/32"-1/2"	1/2"-20UNF	44x90x81mm	0.14mm	290-7053	0.25mm	290-7153	0.35mm	290-7253
1/8"-5/8"	5/8"-16UNF	48x102x92mm	0.20mm	290-7059	0.25mm	290-7159	0.35mm	290-7259

Light duty Keyless Drill chuck



Taper mounted

Capacity	Taper Mount	Dimension DxLxI	Accuracy	Model No.	Accuracy	Model No.	Accuracy	Model No.
1-10mm	B12	42x86x78mm	0.14mm	290-6021	0.25mm	290-6121	0.35mm	290-6221
1-13mm	B16	44x97x88mm	0.14mm	290-6025	0.25mm	290-6125	0.35mm	290-6225
3-16mm	B16	48x102x92mm	0.20mm	290-6029	0.25mm	290-6129	0.35mm	290-6229
3-16mm	B18	48x108x98mm	0.20mm	290-6031	0.25mm	290-6131	0.35mm	290-6231
1/32"-3/8"	JT2	42x86x78mm	0.14mm	290-6049	0.25mm	290-6149	0.35mm	290-6249
1/32"-1/2"	JT6	44x97x88mm	0.14mm	290-6051	0.25mm	290-6151	0.35mm	290-6251
1/32"-1/2"	JT33	44x97x88mm	0.14mm	290-6053	0.25mm	290-6153	0.35mm	290-6253
1/8"-5/8"	JT6	48x102x92mm	0.20mm	290-6055	0.25mm	290-6155	0.35mm	290-6255
1/8"-5/8"	JT3	48x108x98mm	0.20mm	290-6057	0.25mm	290-6157	0.35mm	290-6257

Heavy duty Keyless Drill chuck

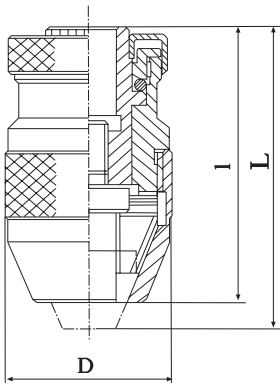

Thread mounted

Capacity	Thread Mount	Dimension DxLxI	Accuracy	Model No.	Accuracy	Model No.	Accuracy	Model No.
0.5-8mm	M10x1	42x91x84mm	0.06mm	290-5401	0.12mm	290-5501	0.20mm	290-5601
1-10mm	M10x1	42x91x84mm	0.06mm	290-5403	0.12mm	290-5503	0.20mm	290-5603
1-13mm	M12x1.25	48x106x97mm	0.06mm	290-5405	0.12mm	290-5505	0.20mm	290-5605
1-16mm	M16x1.5	53x109x101mm	0.07mm	290-5407	0.14mm	290-5507	0.20mm	290-5607
3-16mm	M16x1.5	53x109x101mm	0.07mm	290-5409	0.14mm	290-5509	0.20mm	290-5609
1/64"-5/16"	3/8"-24UNF	42x91x84mm	0.06mm	290-5415	0.12mm	290-5515	0.20mm	290-5615
1/32"-3/8"	3/8"-24UNF	42x91x84mm	0.06mm	290-5417	0.12mm	290-5517	0.20mm	290-5617
1/32"-3/8"	1/2"-20UNF	42x91x84mm	0.06mm	290-5419	0.12mm	290-5519	0.20mm	290-5619
1/32"-1/2"	1/2"-20UNF	48x106x97mm	0.06mm	290-5421	0.12mm	290-5521	0.20mm	290-5621
1/32"-5/8"	1/2"-20UNF	53x109x101mm	0.07mm	290-5423	0.14mm	290-5523	0.20mm	290-5623
1/8"-5/8"	1/2"-20UNF	53x109x101mm	0.07mm	290-5425	0.14mm	290-5525	0.20mm	290-5625

WWW.PRECOTOOLS.CN

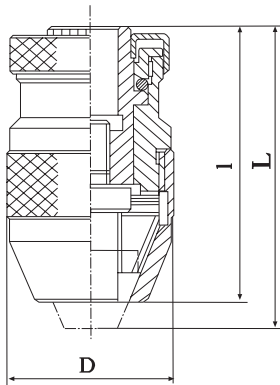
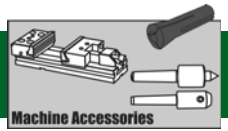

Heavy duty Keyless Drill chuck

Taper mounted

Capacity	Taper Dimension			Model No.	Accuracy	Model No.	Accuracy	Model No.
	Mount	DxLxL1	Accuracy					
0.5-8mm	B12	42x91x84mm	0.06mm	290-5001	0.12mm	290-5101	0.20mm	290-5201
0.5-8mm	B16	42x91x84mm	0.06mm	290-5003	0.12mm	290-5103	0.20mm	290-5203
1-10mm	B12	42x91x84mm	0.06mm	290-5005	0.12mm	290-5105	0.20mm	290-5205
1-10mm	B16	42x91x84mm	0.06mm	290-5007	0.12mm	290-5107	0.20mm	290-5207
1-13mm	B12	48x106x97mm	0.06mm	290-5009	0.12mm	290-5109	0.20mm	290-5209
1-13mm	B16	48x106x97mm	0.06mm	290-5011	0.12mm	290-5111	0.20mm	290-5211
1-16mm	B16	53x109x101mm	0.07mm	290-5013	0.14mm	290-5113	0.20mm	290-5213
1-16mm	B18	53x109x101mm	0.07mm	290-5015	0.14mm	290-5115	0.20mm	290-5215
3-16mm	B16	53x109x101mm	0.07mm	290-5017	0.14mm	290-5117	0.20mm	290-5217
3-16mm	B18	53x109x101mm	0.07mm	290-5019	0.14mm	290-5119	0.20mm	290-5219
5-20mm	B22	62x129x119mm	0.09mm	290-5021	0.18mm	290-5121	0.20mm	290-5221
0.5-6mm	B10	35x67x61mm	0.06mm	290-5023	0.12mm	290-5123	0.20mm	290-5223
0.5-6mm	B12	35x67x61mm	0.06mm	290-5025	0.12mm	290-5125	0.20mm	290-5225
1/64"-5/16"	JT2	42x91x84mm	0.06mm	290-5029	0.12mm	290-5129	0.20mm	290-5229
1/64"-5/16"	JT33	42x91x84mm	0.06mm	290-5031	0.12mm	290-5131	0.20mm	290-5231
1/32"-3/8"	JT2	42x91x84mm	0.06mm	290-5033	0.12mm	290-5133	0.20mm	290-5233
1/32"-3/8"	JT33	42x91x84mm	0.06mm	290-5035	0.12mm	290-5135	0.20mm	290-5235
1/32"-1/2"	JT2	48x106x97mm	0.06mm	290-5037	0.12mm	290-5137	0.20mm	290-5237
1/32"-1/2"	JT33	48x106x97mm	0.06mm	290-5039	0.12mm	290-5139	0.20mm	290-5239
1/32"-1/2"	JT6	48x106x97mm	0.06mm	290-5041	0.12mm	290-5141	0.20mm	290-5241
1/32"-5/8"	JT3	53x109x101mm	0.07mm	290-5043	0.14mm	290-5143	0.20mm	290-5243
1/32"-5/8"	JT6	53x109x101mm	0.07mm	290-5045	0.14mm	290-5145	0.20mm	290-5245
1/8"-5/8"	JT3	53x109x101mm	0.07mm	290-5047	0.14mm	290-5147	0.20mm	290-5247
1/8"-5/8"	JT6	53x109x101mm	0.07mm	290-5049	0.14mm	290-5149	0.20mm	290-5249
3/16"-3/4"	JT3	62x129x119mm	0.09mm	290-5051	0.18mm	290-5151	0.20mm	290-5251
1/64"-1/4"	JT1	35x67x61mm	0.06mm	290-5053	0.12mm	290-5153	0.20mm	290-5253



R8 To Jacobs Taper

Jacobs Taper	R8 Shank Model No.
JT 0	290-0800
JT 1	290-0801
JT 2	290-0802
JT 3	290-0803
JT 4	290-0804
JT 5	290-0805
JT 6	290-0806
JT 33	290-0833

R8 Shank To "B" Taper

"B" Taper	R8 Shank Model No.
B10	290-0810
B12	290-0812
B16	290-0816
B18	290-0818
B22	290-0822
B24	290-0824

DRILL CHUCK ARBORS



MT Shank With Tang To Jacobs Taper

Jacobs Taper	MT0 Model No.	MT1 Model No.	MT2 Model No.	MT3 Model No.	MT4 Model No.	MT5 Model No.	MT6 Model No.
JT 0	290-1000	290-1100	290-1200	290-1300	290-1400	290-1500	290-2700
JT 1	290-1001	290-1101	290-1201	290-1301	290-1401	290-1501	290-2701
JT 2	290-1002	290-1102	290-1202	290-1302	290-1402	290-1502	290-2702
JT 3	290-1003	290-1103	290-1203	290-1303	290-1403	290-1503	290-2703
JT 4	290-1004	290-1104	290-1204	290-1304	290-1404	290-1504	290-2704
JT 5	290-1005	290-1105	290-1205	290-1305	290-1405	290-1505	290-2705
JT 6	290-1006	290-1106	290-1206	290-1306	290-1406	290-1506	290-2706
JT 33	290-1033	290-1133	290-1233	290-1333	290-1433	290-1533	290-2733

MT Shank With Tang To "B" Taper

"B" Taper	MT 0	MT 1	MT 2	MT 3	MT 4	MT 5	MT 6
B 10	290-1010	290-1110	290-1210	290-1310	290-1410	290-1510	290-2710
B 12	290-1012	290-1112	290-1212	290-1312	290-1412	290-1512	290-2712
B 16	290-1016	290-1116	290-1216	290-1316	290-1416	290-1516	290-2716
B 18	290-1018	290-1118	290-1218	290-1318	290-1418	290-1518	290-2718
B 22	290-1022	290-1122	290-1222	290-1322	290-1422	290-1522	290-2722
B 24	290-1024	290-1124	290-1224	290-1324	290-1424	290-1524	290-2724

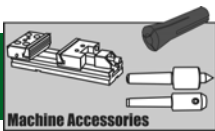

Machine Accessories

DRILL CHUCK ARBORS continued



7:24 Shank To Jacobs Taper

Jacobs Taper	ISO 30 Model No.	ISO 40 Model No.	ISO 45 Model No.	ISO 50 Model No.
JT 0	290-2300	290-2400	290-2600	290-2500
JT 1	290-2301	290-2401	290-2601	290-2501
JT 2	290-2302	290-2402	290-2602	290-2502
JT 3	290-2303	290-2403	290-2603	290-2503
JT 4	290-2304	290-2404	290-2604	290-2504
JT 5	290-2305	290-2405	290-2605	290-2505
JT 6	290-2306	290-2406	290-2606	290-2506
JT 33	290-2333	290-2433	290-2633	290-2533

7:24 Shank To "B" Taper

"B" Taper	ISO Shank			
	ISO 30	ISO40	ISO45	ISO50
B 10	290-2310	290-2410	290-2610	290-2510
B 12	290-2312	290-2412	290-2612	290-2512
B 16	290-2316	290-2416	290-2616	290-2516
B 18	290-2318	290-2418	290-2618	290-2518
B 22	290-2322	290-2422	290-2622	290-2522
B 24	290-2324	290-2424	290-2624	290-2524



Straight Shank To Jacobs Taper

Jacobs Taper	1/2"	5/8"	3/4"	7/8"	1"	1-1/2"	1-3/4"
	Straight Shank Model No.	Straight Shank Model No.	Straight Shank Model No.	Straight Shank Model No.	Straight Shank Model No.	Straight Shank Model No.	Straight Shank Model No.
JT 0	290-1600	290-1700	290-1800	290-1900	290-2000	290-2100	290-2200
JT 1	290-1601	290-1701	290-1801	290-1901	290-2001	290-2101	290-2201
JT 2	290-1602	290-1702	290-1802	290-1902	290-2002	290-2102	290-2202
JT 3	290-1603	290-1703	290-1803	290-1903	290-2003	290-2103	290-2203
JT 4	290-1604	290-1704	290-1804	290-1904	290-2004	290-2104	290-2204
JT 5	290-1605	290-1705	290-1805	290-1905	290-2005	290-2105	290-2205
JT 6	290-1606	290-1706	290-1806	290-1906	290-2006	290-2106	290-2206
JT 33	290-1633	290-1733	290-1833	290-1933	290-2033	290-2133	290-2233

Straight Shank To "B" Taper

"B" Taper	Straight Shank								
	10 mm	12mm	14 mm	16 mm	20 mm	25 mm	32 mm	36 mm	40 mm
B 10	290-1610	290-1640	290-1660	290-1710	290-1810	290-1910	290-2010	290-2110	290-2210
B 12	290-1612	290-1642	290-1662	290-1712	290-1812	290-1912	290-2012	290-2112	290-2212
B 16	290-1616	290-1646	290-1666	290-1716	290-1816	290-1916	290-2016	290-2116	290-2216
B 18	290-1618	290-1648	290-1668	290-1718	290-1818	290-1918	290-2018	290-2118	290-2218
B 22	290-1622	290-1652	290-1672	290-1722	290-1822	290-1922	290-2022	290-2122	290-2222
B 24	290-1624	290-1654	290-1674	290-1724	290-1824	290-1924	290-2024	290-2124	290-2224

MT Shank With Draw Bar To Jacobs Taper

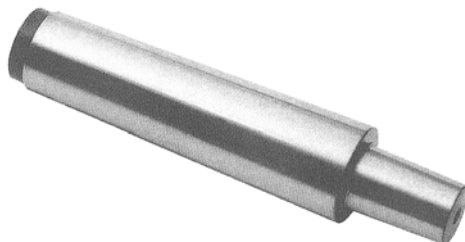

Jacobs Taper	MT 0	MT 1	MT 2	MT 3	MT 4	MT 5
JT 0	290-3000	290-3100	290-3200	290-3300	290-3400	290-3500
JT 1	290-3001	290-3101	290-3201	290-3301	290-3401	290-3501
JT 2	290-3002	290-3102	290-3202	290-3302	290-3402	290-3502
JT 3	290-3003	290-3103	290-3203	290-3303	290-3403	290-3503
JT 4	290-3004	290-3104	290-3204	290-3304	290-3404	290-3504
JT 5	290-3005	290-3105	290-3205	290-3305	290-3405	290-3505
JT 6	290-3006	290-3106	290-3206	290-3306	290-3406	290-3506
JT 33	290-3033	290-3133	290-3233	290-3333	290-3433	290-3533

MT Shank With Draw Bar To "B" Taper

"B" Taper	MT 0	MT 1	MT 2	MT 3	MT 4	MT 5
B 10	290-3010	290-3110	290-3210	290-3310	290-3410	290-3510
B 12	290-3012	290-3112	290-3212	290-3312	290-3412	290-3512
B 16	290-3016	290-3116	290-3216	290-3316	290-3416	290-3516
B 18	290-3018	290-3118	290-3218	290-3318	290-3418	290-3518
B 22	290-3022	290-3122	290-3222	290-3322	290-3422	290-3522
B 24	290-3024	290-3124	290-3224	290-3324	290-3424	290-3524