

Machine Accessories

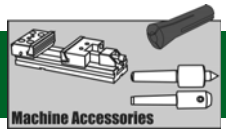

ECONOMY ADAPT CLAMP KIT

Better Performance with just 21 pieces

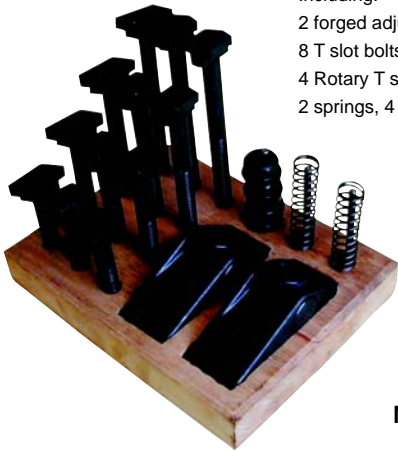

- Including:
 2 forged adjusta clamps
 8 T slot bolts, two each of 2,4,5,6"
 4 Rotary T slot bolts 3,4,5,6"
 2 springs, 4 flange nuts, and 1 sturdy holder.

Model No. 400-8032

T-SLOT CLEANER



A must for every machine shop

Model No. 400-0000

ELECTRONIC EDGE FINDERS

- It is used for CNC
- Tooth point LED indicator
- Be made of high quality alloy steel
- Concentricity 0.01mm

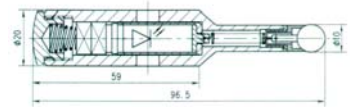

Model No.287-0300

52-PC. METRIC CLAMPING KIT

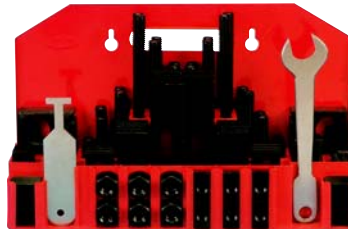

Size	Model No.
M10	400-3010
M12	400-3012
M14	400-3014
M16	400-3016

COUPLING NUTS



A	L	B	Model No.
M10	24	17	407-4110
M12	32	19	407-4112
M14	32	19	407-4114
M16	40	24	407-4116

FLANGED NUTS

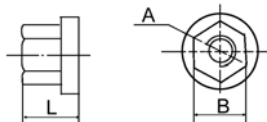

A	L	B	Model No.
M10	12	17	407-5010
M12	17	19	407-5012
M14	17	19	407-5014
M16	20	24	407-5016

T-SLOT NUTS

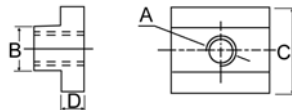

A	B	C	D	Model No.
M10	11.70	22	7.1	407-2310
M12	13.70	25	8	407-2312
M14	15.70	25	8	407-2314
M16	17.70	31	11	407-2316

STEP BLOCKS

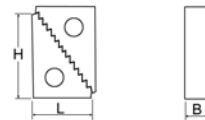

L	H	B	Model No.
19.05	27.30	25	407-6210
26.99	39.60	25	407-6220
63.50	96.00	25	407-6230
50.80	77.30	27	407-6240
76.20	115	27	407-6250

DOUBLE END BOLTS



A	L	I	Model No.	A	L	I	Model No.
M10	76	28	407-8005	M14	76	28	407-8065
M10	102	32	407-8010	M14	102	38	407-8070
M10	127	32	407-8015	M14	127	38	407-8075
M10	152	32	407-8020	M14	152	38	407-8080
M10	178	32	407-8025	M14	178	38	407-8085
M10	203	32	407-8030	M14	203	38	407-8090
M12	76	28	407-8035	M16	76	28	407-8095
M12	102	38	407-8040	M16	102	45	407-8100
M12	127	38	407-8045	M16	127	45	407-8105
M12	152	38	407-8050	M16	152	45	407-8110
M12	178	38	407-8055	M16	178	45	407-8115
M12	203	38	407-8060	M16	203	45	407-8120

STEP CLAMPS

For Bolt	L	B	H	Model No.
M10	63.5	25	12	407-8205
M10	101.6	25	15	407-8210
M10	152.4	28	19	407-8215
M12	63.5	28	12	407-8220
M12	101.6	31	19	407-8225
M12	152.4	31	22	407-8230
M14	63.5	28	12	407-8235
M14	101.6	31	19	407-8240
M14	152.4	31	22	407-8245
M16	101.6	38	19	407-8250
M16	152.4	38	22	407-8255

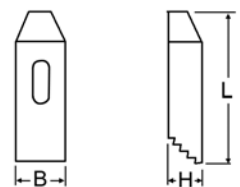



Machine Accessories

52-PCS DELUXE STEEL CLAMPING KIT

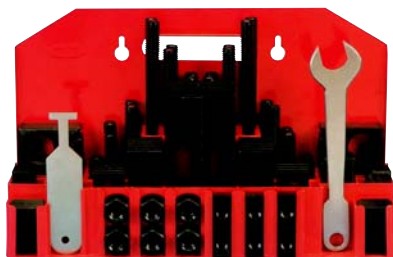

Each set contains

- 6 T-slot nuts.
- 6 flange nuts.
- 4 coupling nuts.
- 6 step blocks.
- 6 serrated end clamps.
- 24 studs, 4 each: 3", 4", 5", 6", 7", 8" lg. 1 holder.

- * Nut Wrench - FREE.
- * Slot Cleaner - FREE.

Table Slot	Stud Size	Metal Holder Model No.	Plastic Holder Model No.
3/8"	5/16"-18	400-2375	400-3375
7/16"	3/8" -16	400-2437	400-3437
9/16"	1/2" -13	400-2562	400-3562
1/2"	3/8" -16	400-2501	400-3501
5/8"	1/2" -13	*400-2626	*400-3626
3/4"	5/8" -11	400-2750	400-3750

50-PCS SUPER CLAMP SETS

With Steel Blocks

Each set contains

- 24 studs with flats, 4 each: 3", 4", 5", 6", 7", 8", lg.
- 4 coupling nut.
- 4 flange nuts.
- 6 serrated end clamps.
- 6 T slot nut.
- 6 step blocks.
- 1 T-slot cleaner-FREE.
- 1 holder-FREE.



Table Slot	Stud Size	Model No.
3/8"	5/16-18	400-4375
5/8"	1/2-13	400-4626

38-PCS T-NUT & STUD SETS

- 4 flange nuts
- 4 T-slot nuts
- 4 coupling nuts
- 1 T-slot cleaner
- 24 studs, 4 each: 3", 4", 5", 6", 7", 8"lg
- 1 Holder



Table Slot	Stud Size	Model No.
7/16"	3/8-16	402-4437
9/16"	1/2-13	402-4562
5/8"	1/2-13	402-4625
3/4"	5/8-11	402-4750

FLANGED NUTS

- heat treated steel black oxide finished.

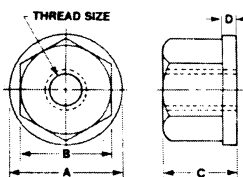

Thread Size	A	B	C	D	Model No.
5/16-18	11/16	1/2	9/32	1/8	407-5020
3/8-16	3/4	9/16	9/32	1/8	407-5024
1/2-13	1-5/32	7/8	1/2	3/16	407-5032
5/8-11	1-5/16	15/16	5/8	3/16	407-5040
3/4-10	1-1/2	1-1/8	21/32	1/4	407-5048
7/8-9	1-3/4	1-5/16	3/4	1/4	407-5056
1-8	2	1-1/2	7/8	1/4	407-5064



COUPLING NUTS

- heated treated steel black oxide finished.

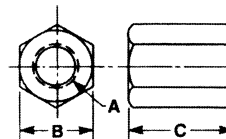

Thread Size	Hex Size A	Hex Size B	Length C	Model No.
3/8-16	11/16	1	1	407-4024
5/16-18	9/16	7/8	7/8	407-4020
1/2-13	7/8	1-1/4	1-1/4	407-4032
5/8-11	1-1/16	1-5/8	1-5/8	407-4040
3/4-10	1-1/4	1-7/8	1-7/8	407-4048
7/8-9	1-7/16	2-1/4	2-1/4	407-4056
1-8	1-5/8	2-1/2	2-1/2	407-4064



T-SLOT NUTS

- Heat treated steel black oxide finished.
- An imperfect thread is left in the base of the T-nut to eliminate any danger of screwing stud through.
- T-nut and damaging table slot

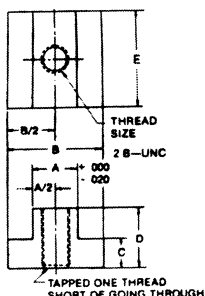

Thread Size	Table Slot A	B	C	D	E	Model No.
5/16-18	3/8	5/8	3/16	1/2	7/8	407-2202
3/8-16	7/16	11/16	7/32	1/2	7/8	407-2204
3/8-16	1/2	7/8	9/32	1/2	7/8	407-2206
3-8/16	9/16	7/8	11/32	5/8	1-1/8	407-2208
1/2-13	9/16	7/8	11/32	5/8	1-1/8	407-2210
1/2-13	5/8	1	11/32	5/8	1-1/8	407-2212
1/2-13	11/16	1-1/8	7/16	3/4	1-1/4	407-2214
5/8-11	11/16	1-1/8	7/16	3/4	1-1/4	407-2216
5/8-11	3/4	1-1/4	15/32	3/4	1-1/4	407-2218
5/8-11	13/16	1-1/4	9/16	1	1-1/2	407-2220
3/4-10	13/16	1-1/4	9/16	1	1-1/2	407-2222
3/4-10	7/8	1-1/2	9/16	1	1-1/2	407-2224
3/4-10	1	1-5/8	5/8	1	1-3/4	407-2226
3/4-10	1-1/16	1-5/8	11/16	1	2	407-2228
7/8-9	1	1-5/8	5/8	1	1-3/4	407-2230
1/8	1-1/16	1-5/8	11/16	1	2	407-2232

Machine Accessories

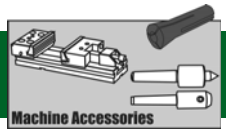

CLAMPING STUDS

- Heat treated steel
- Black oxide finished
- Studs threaded the same on both ends

OAL Length	A-1-1/8" 5-16-18 Model No.	A-1-1/4" 3/8-16 Model No.	A-1-1/2" 1/2-13 Model No.	A-1-3/4" 5/8-11 Model No.	A-2" 3/4-10 Model No.	A-2-1/4" 7/8-9 Model No.	A-2-1/2" 1-8 Model No.
1-1/2"	407-0115	407-0215	407-0315				
2"	407-0120	407-0220	407-0320	407-0420			
2-1/2"	407-0125	407-0225	407-0325				
3"	407-0130	407-0230	407-0330	407-0430	407-0530	407-0630	407-0730
3-1/2"		407-0235	407-0335	407-0435			
4"	407-0140	407-0240	407-0340	407-0440	407-0540	407-0640	407-0740
4-1/2"		407-0245	407-0345	407-0445			
5"	407-0150	407-0250	407-0350	407-0450	407-0550	407-0650	407-0750
5-1/2"		407-0255	407-0355	407-0455			
6"	407-0160	407-0260	407-0360	407-0460	407-0560	407-0660	407-0760
6-1/2"		407-0265	407-0365	407-0465			
7"	407-0170	407-0270	407-0370	407-0470	407-0570	407-0670	407-0770
7-1/2"	407-0175	407-0275	407-0375	407-0475			
8"	407-0180	407-0280	407-0380	407-0480	407-0580	407-0680	407-0780
10"			407-0390	407-0490	407-0590	407-0690	407-0790
12"			407-0392	407-0492	407-0592	407-0692	407-0792
14"			407-0394	407-0494	407-0594	407-0694	407-0794
16"					407-0596	407-0696	407-0796
18"					407-0598	407-0698	407-0798
20"					407-0599	407-0699	407-0799

PLAIN CLAMP

Heat treated steel black oxide finished

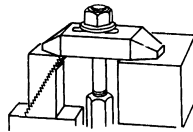

Bolt Size	Length	Width	Thickness	Model No.
5/16 or 3/8	2-1/2	1	1/2	410-7002
5/16 or 3/8	4	1	5/8	410-7004
5/16 or 3/8	6	1-1/8	3/4	410-7006
1/2	2-1/2	1-1/8	1/2	410-7008
1/2	4	1-1/4	3/4	410-7010
1/2	6	1-1/4	7/8	410-7012
5/8	2-1/2	1-1/4	5/8	410-7014
5/8	4	1-1/2	3/4	410-7016
5/8	6	1-1/2	7/8	410-7018
3/4	4	1-1/2	3/4	410-7020
3/4	6	1-1/2	1	410-7022
3/4	8	1-3/4	1-1/8	410-7024
1	6	2	1-1/4	410-7026
1	8	2	1-3/8	410-7028
1	10	2	1-1/2	410-7030

STEP CLAMP

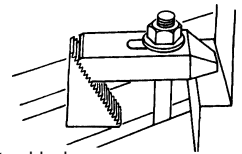

- Step clamp teeth are matched to fit anysize step block.
- Heat treated steel black oxide finished.
- 1/2" & 5/8" bolt size clamps forged & hardened.

Bolt Size	Length	Width	Thickness	Model No.
5/16 or 3/8	2-1/2	1	1/2	410-7702
5/16 or 3/8	4	1	5/8	410-7704
5/16 or 3/8	6	1-1/8	3/4	410-7706
1/2	2-1/2	1-1/8	1/2	410-7708
1/2	4	1-1/4	3/4	410-7710
1/2	6	1-1/4	7/8	410-7712
5/8	2-1/2	1-1/4	5/8	410-7714
5/8	4	1-1/2	3/4	410-7716
5/8	6	1-1/2	7/8	410-7718
3/4	4	1-1/2	3/4	410-7720
3/4	6	1-1/2	1	410-7722
3/4	8	1-3/4	1-1/8	410-7724
7/8 or 1	8	2	1-1/4	410-7726
7/8 or 1	8	2	1-3/8	410-7728
7/8 or 1	10	2	1-1/2	410-7730



DELUXE STEP BLOCKS

- Solid in pairs only.
- Standard steel and powder casting.

Capacity of Full Block	Height Of 1/2 Block	Powder Casting Model No	Steel Model No.
3/4 to 1/2	1-1/8	407-6110	407-6010
1-1/8 to 2-1/2	1-3/4	407-6120	407-6020
2-1/2 to 6	3-7/8	407-6130	407-6030

Heavy Duty Steel 1-1/2" Wide

Capacity of Full Block	Height Of 1/2 Block	Powder Casting Model No	Steel Model No.
1-1/2 to 3-3/4	2-1/2	407-6140	407-6040
2-1/2 to 6	3-7/8	407-6150	407-6050
3-1/2 to 9	5-1/2	407-6161	407-6060

Double Duty Steel 2" Wide

Capacity of Full Block	Height Of 1/2 Block	Powder Casting Model No	Steel Model No.
1-1/2 to 3-3/4	2-1/2	407-6170	407-6070
2-1/2 to 6	3-7/8	407-6180	407-6080
3-1/2 to 9	5-1/2	407-6190	407-6090